

NOTES:

1. SUPPLIER CERTIFIES PRODUCT IS ROHS COMPLIANT.
2. REMOVE ALL BURRS & SHARP EDGES.
3. ESTIMATED MASS: 6.87 GRAMS

REVISIONS		
REV.	DESCRIPTION	DATE
R0	ORIGINAL DESIGN	

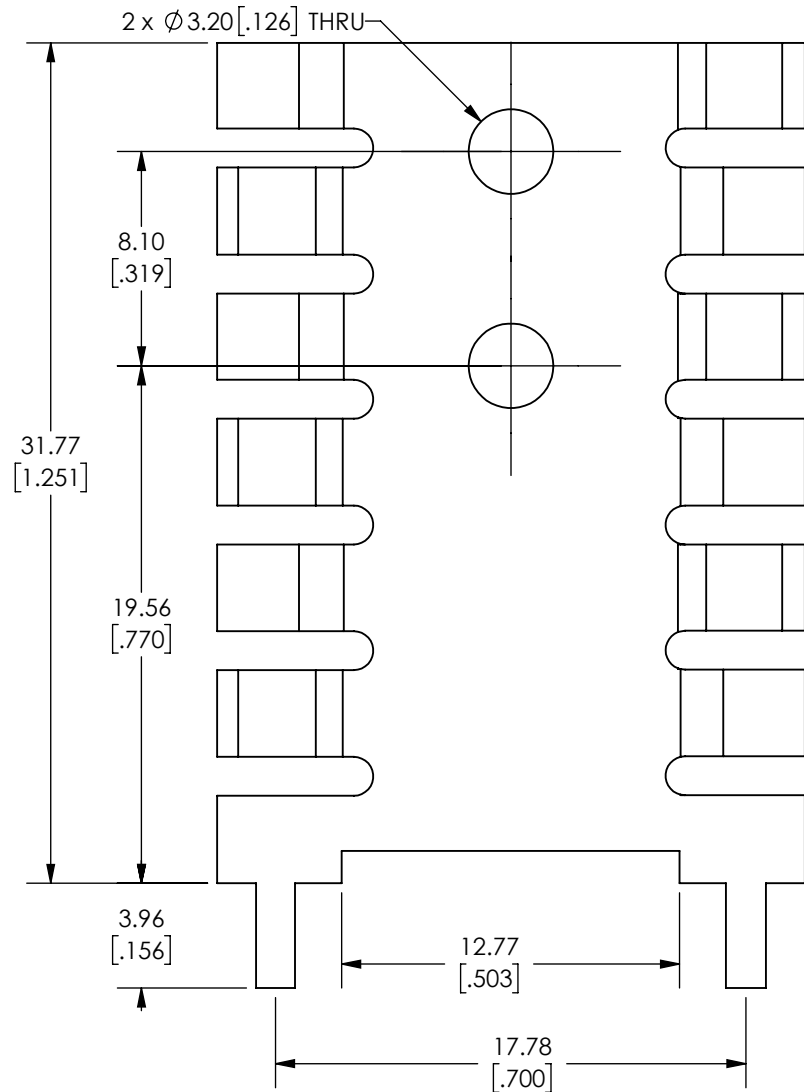

Front View
Scale 7:2

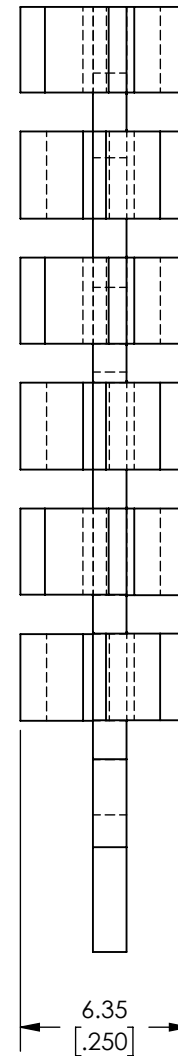

Side View
Scale 7:2

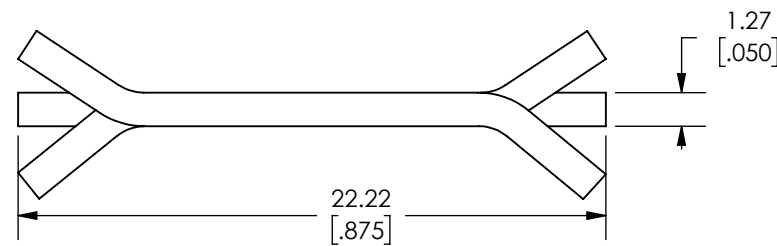

Bottom View
Scale 7:2

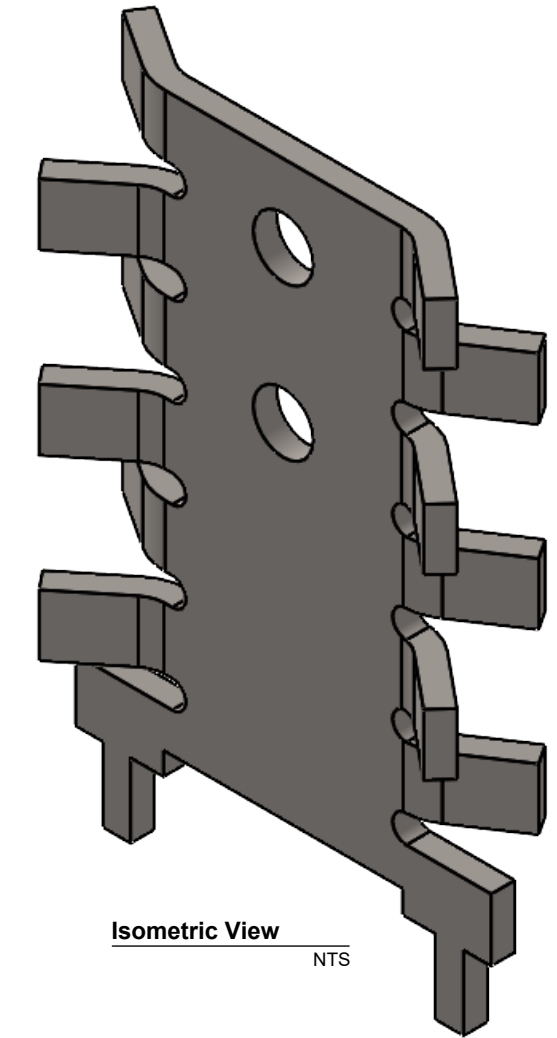

Isometric View
NTS



89-27 Access Road
Norwood MA, 02062

DWN:
FW

DESIGNER:
FW

APPROVED / RELEASED
FOR ATS MANUFACTURE:

DESCRIPTION:
HEAT SINK

TOLERANCE:
UNLESS OTHERWISE SPECIFIED:
X.X +/- 0.5mm
X.XX +/- 0.25mm
X.XXX +/- 0.125mm
ANGLES +/- 1°

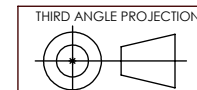

DRW UNITS:
MM(IN)

SCALE:
NTS

DWG. NO.

FINISH:
TIN PLATED

ATS-PCB1059

MATERIAL:
COPPER

LEVEL
--

DATE:
6/10/2020

SHEET#
1 OF 1